

QUICK START GUIDE

US EN

For a full explanation of all features and instructions, please refer to the User's Guide.(available for download from motorolanursery.com).

1. Setting up your Digital Video Baby Monitor

A. Connecting the Power Supply of the Parent Unit.

A rechargeable battery (Lithium ion battery 2000mAh) inside the Parent Unit allows you to move it without losing the link and picture from the Baby Unit. We recommend charging the for at least 16 hours before first use, and when the Parent Unit indicates the battery is low.

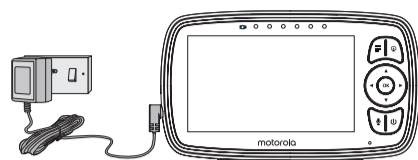

- Connect the small plug of the power adapter to the parent unit and the other end to the electrical outlet. Only use the enclosed adapter (5VDC/1000mA).
- Press and hold the **⏻** button to turn the Parent unit on, the Parent unit and Baby unit are automatically linked and ready to use.

⚠ WARNING:

Strangulation hazard. Children have STRANGLED in cords. Keep this cord out of the reach of children (more than 3 feet away). Never use extension cords with AC Adapters. Only use the AC Adapters provided.

MODÈLES:
VM44 CONNECT,
VM44-2 CONNECT,
VM44-3 CONNECT,
VM44-4 CONNECT

GUIDE DE DÉMARRAGE RAPIDE

CA FR

Pour les caractéristiques et les instructions complètes, veuillez vous référer au Guide de l'utilisateur. (téléchargeable sur motorolanursery.com).

1. Installation de votre moniteur vidéo numérique pour bébé

A. Alimentation électrique de l'unité parents.

La batterie rechargeable au lithium-ion de 2000 mAh intégrée à l'unité parents vous permet de déplacer cette dernière sans perdre la liaison et les images de l'unité bébé. Nous vous recommandons de le charger pendant au moins 16 heures avant la première utilisation, et lorsque l'unité parent indique que la batterie est faible.

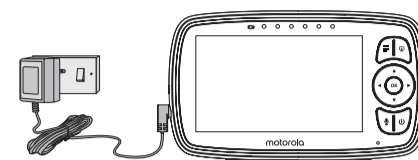

- Connectez le jack de l'adaptateur secteur à la prise de l'unité parents et l'adaptateur à une prise de courant. Utilisez uniquement l'adaptateur secteur 5 Vcc/1000 mA fourni.
- Maintenez le bouton **⏻** enfoncé pour allumer l'unité parent. L'unité parent et l'unité bébé sont automatiquement liés et prêts à utiliser.

⚠ AVERTISSEMENT:

Danger d'étranglement : des enfants se sont accidentellement ÉTRANGLÉS avec les cordons. Tenez ce cordon hors de portée des enfants (à plus d'un mètre / 3 pieds de distance). N'utilisez jamais de prolongateurs avec les adaptateurs secteur. Utilisez uniquement les adaptateurs secteur fournis.

MODELOS:
VM44 CONNECT,
VM44-2 CONNECT,
VM44-3 CONNECT,
VM44-4 CONNECT

GUÍA DE INICIO RÁPIDO.

ES LA

Para obtener una explicación más detallada de todas las funciones e instrucciones, consulte la Guía de usuario (la puede descargar en motorolanursery.com).

1. Configuración de su Monitor para bebés con video digital.

A. Conectar el suministro eléctrico de la Unidad para los padres.

Una batería recargable (batería de iones de litio 2000mAh) dentro de la Unidad para los padres le permite moverla sin perder el enlace ni la imagen de la Unidad para el bebé. Le recomendamos que cargue la unidad por 16 horas como mínimo antes de utilizarla por primera vez, o cuando la Unidad para los padres indique que la carga de batería está baja.

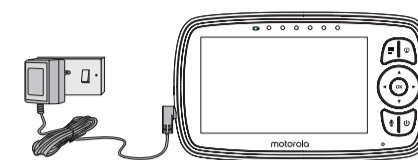

- Conecte el enchufe pequeño del transformador a la unidad para los padres y el otro extremo al tomacorriente. Solo utilice el transformador que se adjunta (5V CC/1000mA).
- Mantenga presionado el botón de Encendido Apagado **⏻** para encender la unidad de padres, la unidad de los padres y la unidad del bebé están sincronizadas en automático y se encuentran listas para usarse.

⚠ PRECAUCIÓN:

Peligro de estrangulamiento: Se han presentado casos de ESTRANGULAMIENTO de niños con cables. Mantenga este cable fuera del alcance de los niños (a más de 3 pies (1m)). Nunca utilice cables de extensión con transformadores de CA. Solo utilice los transformadores de CA.

B. Desktop Stand of the Parent Unit

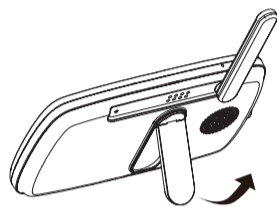

- The parent unit comes with a desktop stand attached to the back of the parent unit.
- To place the parent unit on a desk, simply pull out the stand, as shown.

NOTE

Place the parent unit on a flat, even surface.

C. Connecting the Power Supply for the Baby Unit

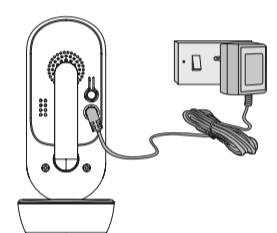

- Insert the DC plug of the power adapter into the DC socket on the back of the Baby Unit.
- Connect the other end of the power adapter to a suitable electrical outlet.
- The baby unit turns on and the power indicator lights in Blue colour.

NOTE

Only use the supplied power adapter (DC5V/1000mA).

NOTE:

When the Baby and Parent Units are both turned on and within range, the Parent Unit should show a color image from the Baby Unit camera, but if the room is dark, the image will be in black and white, with an **👁** icon showing, due to the infra-red illumination by the Baby Unit.

B. Support de bureau de l'unité parent

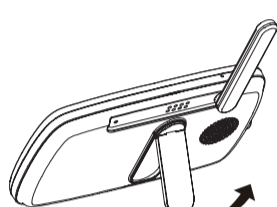

- L'unité parents est livrée avec un support de table au dos de l'appareil.
- Pour poser l'unité parents sur une table, il suffit de tirer sur le support, comme montré cicontre.

REMARQUE

Posez l'unité parents sur une surface plane et horizontale.

C. Alimentation électrique de l'unité bébé

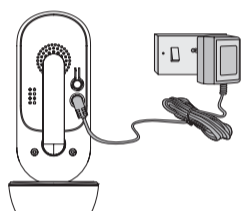

- Insérez la fiche CC de l'adaptateur secteur dans la prise CC située au dos de l'unité bébé.
- Branchez l'adaptateur à une prise de courant.
- L'unité bébé s'allume et le voyant d'alimentation s'illumine en bleu.

REMARQUE

Utilisez uniquement l'adaptateur secteur fourni (5Vcc/1000 mA).

REMARQUE :

Lorsque l'unité bébé et l'unité parents sont toutes les deux sous tension, les images capturées par la caméra de l'unité bébé s'affichent en couleur sur l'unité parents, mais si la pièce est sombre les images sont en noir et blanc et l'icône **👁** s'affiche, en raison de l'éclairage infrarouge provenant de l'unité bébé.

B. Soporte de escritorio de la unidad para padres.

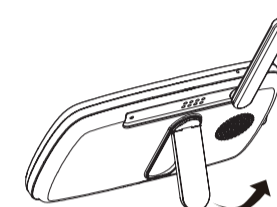

- La unidad para los padres viene con un soporte para escritorio ubicado en la parte posterior de la unidad.
- Para colocar la unidad para los padres sobre un escritorio, simplemente tire del soporte.

NOTA

Coloque la unidad para los padres sobre una superficie plana y uniforme.

C. Suministro de energía de la unidad para el bebé.

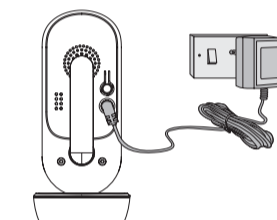

- Inserte el enchufe de CC del transformador en la entrada de CC ubicada en la parte posterior de la Unidad para el bebé.
- Conecte el otro extremo del transformador a una toma de corriente adecuada.
- La unidad del bebé se encenderá y el indicador de encendido se iluminará en color azul.

NOTA

Sólo utilice el transformador que se proporciona (5V CC/1000mA).

NOTA:

Cuando la Unidad para el bebé y la Unidad para los padres están encendidas y dentro del alcance, en la Unidad para los padres debe aparecer una imagen a color capturada por la cámara de la Unidad para el bebé, pero si la habitación está oscura la imagen será en blanco y negro, con un icono **👁** que así lo indica, debido a la iluminación infrarroja de la Unidad para el bebé.

2. Basic operation of the keys

Parent unit		
⏻	ON/OFF button	Press and hold to switch the Parent Unit ON/OFF.
▲▼	UP/DOWN buttons	Press to select brightness level of Parent Unit. Press to adjust menu setting when menu is active.
◀▶	LEFT/RIGHT buttons	Press to adjust volume level. Press to access menu options when menu is active.
☰	MENU button	Press to open menu options or exit the menu.
OK	OK button	Press to confirm a selection.
📺	VIDEO button	Press to turn the LCD screen ON/OFF.
🗣	TALK button	Press and hold to talk to your baby.
🔄	RESET button	Press and hold with a small pin to reset the unit.
Baby Unit		
🔗	PAIR button	Press and hold to pair with the parent unit or Motorola Nursery Wi-Fi® Setup.

2. Basic operation of the keys

Parent unit		
⏻	Touche MARCHÉ/ARRÊT	Appuyez longuement pour mettre l'unité parents sous ou hors tension.
▲▼	Touches HAUT/BAS	Appuyez pour sélectionner le niveau de luminosité de l'unité parent. Appuyez pour régler les paramètres du menu lorsque le menu est actif.
◀▶	Touches GAUCHE/DROITE	Appuyez pour régler le volume. Appuyez pour accéder aux options du menu lorsque le menu est actif.
☰	Touche MENU	Appuyez pour ouvrir le menu ou pour sortir.
OK	Touche OK	Appuyez pour confirmer une sélection.
📺	Touche VIDÉO	Appuyez pour activer ou désactiver l'écran LCD.
🗣	Touche PAROLE	Maintenez cette touche enfoncée pour parler à votre bébé.
🔄	Bouton de RÉINITIALISATION	Appuyez longuement avec un objet pointu (par ex. une épingle) pour réinitialiser l'appareil.
Baby Unit		
🔗	Bouton de COUPLAGE	Appuyez et maintenez-le enfoncé pour jumeler l'unité parente ou la configuration Motorola Nursery Wi-Fi®.

2. Funcionamiento básico de los botones.

Unidad para los padres		
⏻	Botón de ENCENDIDO/APAGADO	Mantenga presionado para ENCENDER/APAGAR la Unidad para los padres.
▲▼	Botones ARRIBA/ABAJO	Presione para seleccionar el nivel de brillo de la unidad para padres. Presione para ajustar las configuraciones del menú.
◀▶	Botones IZQUIERDA/DERECHA	Presione para ajustar o el nivel del volumen. Presione para acceder a diferentes opciones del menú.
☰	Botón MENÚ	Presione para abrir las opciones del menú o para salir del mismo.
OK	Botón ACEPTAR	Presione para confirmar la selección.
📺	Botón de VIDEO	Presione para ENCENDER/APAGAR la pantalla LCD.
🗣	Botón HABLAR	Mantenga presionado para hablarle a su bebé.
🔄	Botón de REINICIO	Mantenga presionado con un alfiler pequeño para reiniciar la unidad.
Unidad para el bebé		
🔗	Botón de SINCRONIZACIÓN	Mantenga presionado para sincronizar con la unidad de padres o con los ajustes de Motorola Nursery Wi-Fi®.

3. Setting up the Baby Unit for Wi-Fi® internet viewing

A. Install Motorola Nursery App.



- Scan the QR code with your smart device and download Motorola Nursery App from the App Store for iOS devices or from the Google Play™ Store for Android™ devices.
- Install Motorola Nursery App on your device.

B. View on Compatible Smartphones and Tablets.



1. Open the Motorola Nursery App on your compatible smartphone or tablet.
2. Follow the in-app instructions to create your account and connect to your device.

Please take note of the following minimum system requirements:
Smartphones/Tablets: iOS 9.0, Android™ 5.0

Wi-Fi® requirements:

At least 0.6 Mbps upload bandwidth per Smart Monitoring Companion, test your internet speed at: <http://www.speedtest.net/>

3. Installation de la caméra avec visionnage Wi-Fi® sur Internet

A. Installation de l'application Motorola Nursery.



- Scannez le code QR avec votre appareil intelligent et téléchargez l'application Motorola Nursery de la boutique App Store pour les appareils iOS ou de la boutique Google Play™ pour les appareils Android™.
- Installez l'application Motorola Nursery sur votre appareil intelligent.

B. Visionnez les images sur un Smartphone ou une tablette compatibles.



1. Démarrez l'application Motorola Nursery sur votre smartphone ou votre tablette compatible.
2. Suivez les instructions de l'application pour créer votre compte et vous connecter à votre caméra Wi-Fi®.

Veuillez noter les configurations système minimales suivantes :
Smartphones/Tablettes: iOS 8, Android™ 5.0

Exigences Wi-Fi® :

Bande passante de téléchargement ≥ 0,6 Mbps par caméra. Testez la vitesse de votre connexion Internet sur : <http://www.speedtest.net/>

3. Configuración de la cámara para su visualización por Internet a través de Wi-Fi®

A. Instalar la aplicación Motorola Nursery.



- Escanee el código QR con su dispositivo inteligente y descargue la aplicación Motorola Nursery de App Store para dispositivos iOS o de Google Play™ Store para dispositivos Android™.
- Instale la Aplicación Motorola Nursery en su dispositivo.

B. Ver en Teléfonos inteligentes y tabletas compatibles.



1. Abra la aplicación Motorola Nursery en su teléfono inteligente o tablet compatible.
2. Siga las instrucciones en la aplicación para crear su cuenta y conectarse a su Cámara Wi-Fi®.

Por favor, tome nota de los siguientes requisitos mínimos del sistema:
Teléfonos inteligentes/Tablets: iOS 8, Android™ 5.0

Requisitos Wi-Fi®:

Al menos 0.6 Mbps de banda ancha para cargar por cámara. Puede comprobar la velocidad de su conexión a Internet en: <http://www.speedtest.net/>

4. General Information

If your product is not working properly, read this Quick Start Guide or the User’s Guide of one of the models listed on page 1.

Please visit us at: motorolanursery.com/support

Exclusions

Consumer Products and Accessories Limited Warranty (“Warranty”)
Thank you for purchasing this Motorola branded product manufactured under license by Meizhou Guo Wei Electronics Co., Ltd. (“MZGW”).

What Does this Warranty Cover?

Subject to the exclusions contained below, MZGW warrants that this Motorola branded product (“Product”) or certified accessory (“Accessory”) sold for use with this product that it manufactured to be free from defects in materials and workmanship under normal consumer usage for the period outlined below. This Warranty is your exclusive warranty and is not transferable.

THIS WARRANTY GIVES YOU SPECIFIC LEGAL RIGHTS, AND YOU MAY HAVE OTHER RIGHTS THAT VARY BY STATE, PROVINCE OR COUNTRY. FOR CONSUMERS WHO ARE COVERED BY CONSUMER PROTECTION LAWS OR REGULATIONS IN THEIR COUNTRY OF PURCHASE OR, IF DIFFERENT, THEIR COUNTRY OF RESIDENCE, THE BENEFITS CONFERRED BY THIS LIMITED WARRANTY ARE IN ADDITION TO ALL RIGHTS AND REMEDIES CONVEYED BY SUCH CONSUMER PROTECTION LAWS AND REGULATIONS. FOR A FULL UNDERSTANDING OF YOUR RIGHTS YOU SHOULD CONSULT THE LAWS OF YOUR COUNTRY, PROVINCE OR STATE.

Who is covered?

This Warranty extends only to the first consumer purchaser, and is not transferable.

What will MZGW do?

MZGW or its authorized distributor at its option and within a commercially reasonable time, will at no charge repair or replace any Products or Accessories that do not conform to this Warranty. We may use functionally equivalent reconditioned/ refurbished/ pre-owned or new Products, Accessories or parts.

Exclusions

Normal Wear and Tear. Periodic maintenance, repair and replacement of parts due to normal wear and tear are excluded from coverage.

Abuse & Misuse. Defects or damage that result from: (a) improper operation, storage, misuse or abuse, accident or neglect, such as physical damage (cracks, scratches, etc.) to the surface of the product resulting from misuse; (b) contact with liquid, water, rain, extreme humidity or heavy perspiration, sand, dirt or the like, extreme heat, or food; (c) use of the Products or Accessories for commercial purposes or subjecting the Product or Accessory to abnormal usage or conditions; or (d) other acts which are not the fault of MOTOROLA or MZGW, are excluded from coverage.

Use of Non-Motorola branded Products and Accessories. Defects or damage that result from the use of Non-Motorola branded or certified Products or Accessories or other peripheral equipment are excluded from coverage.

Unauthorized Service or Modification. Defects or damages resulting from service, testing, adjustment, installation, maintenance, alteration, or modification in any way by someone other than MOTOROLA, MZGW or its authorized service centers, are excluded from coverage.

Altered Products. Products or Accessories with (a) serial numbers or date tags that have been removed, altered or obliterated; (b) broken seals or that show evidence of tampering; (c) mismatched board serial numbers; or (d) nonconforming or non-Motorola branded housings, or parts, are excluded from coverage.

Communication Services. Defects, damages, or the failure of Products or Accessories due to any communication service or signal you may subscribe to or use with the Products or Accessories is excluded from coverage.

How to Obtain Warranty Service or Other Information?

To obtain service or information, please visit us at: motorolanursery.com/support

Exclusions

Normal Wear and Tear. Periodic maintenance, repair and replacement of parts due to normal wear and tear are excluded from coverage.

Abuse & Misuse. Defects or damage that result from: (a) improper operation, storage, misuse or abuse, accident or neglect, such as physical damage (cracks, scratches, etc.) to the surface of the product resulting from misuse; (b) contact with liquid, water, rain, extreme humidity or heavy perspiration, sand, dirt or the like, extreme heat, or food; (c) use of the Products or Accessories for commercial purposes or subjecting the Product or Accessory to abnormal usage or conditions; or (d) other acts which are not the fault of MOTOROLA or MZGW, are excluded from coverage.

Use of Non-Motorola branded Products and Accessories. Defects or damage that result from the use of Non-Motorola branded or certified Products or Accessories or other peripheral equipment are excluded from coverage.

Unauthorized Service or Modification. Defects or damages resulting from service, testing, adjustment, installation, maintenance, alteration, or modification in any way by someone other than MOTOROLA, MZGW or its authorized service centers, are excluded from coverage.

Altered Products. Products or Accessories with (a) serial numbers or date tags that have been removed, altered or obliterated; (b) broken seals or that show evidence of tampering; (c) mismatched board serial numbers; or (d) nonconforming or non-Motorola branded housings, or parts, are excluded from coverage.

Communication Services. Defects, damages, or the failure of Products or Accessories due to any communication service or signal you may subscribe to or use with the Products or Accessories is excluded from coverage.

How to Obtain Warranty Service or Other Information?

To obtain service or information, please visit us at: motorolanursery.com/support

Exclusions

Normal Wear and Tear. Periodic maintenance, repair and replacement of parts due to normal wear and tear are excluded from coverage.

Abuse & Misuse. Defects or damage that result from: (a) improper operation, storage, misuse or abuse, accident or neglect, such as physical damage (cracks, scratches, etc.) to the surface of the product resulting from misuse; (b) contact with liquid, water, rain, extreme humidity or heavy perspiration, sand, dirt or the like, extreme heat, or food; (c) use of the Products or Accessories for commercial purposes or subjecting the Product or Accessory to abnormal usage or conditions; or (d) other acts which are not the fault of MOTOROLA or MZGW, are excluded from coverage.

Use of Non-Motorola branded Products and Accessories. Defects or damage that result from the use of Non-Motorola branded or certified Products or Accessories or other peripheral equipment are excluded from coverage.

Exclusions

Normal Wear and Tear. Periodic maintenance, repair and replacement of parts due to normal wear and tear are excluded from coverage.

Abuse & Misuse. Defects or damage that result from: (a) improper operation, storage, misuse or abuse, accident or neglect, such as physical damage (cracks, scratches, etc.) to the surface of the product resulting from misuse; (b) contact with liquid, water, rain, extreme humidity or heavy perspiration, sand, dirt or the like, extreme heat, or food; (c) use of the Products or Accessories for commercial purposes or subjecting the Product or Accessory to abnormal usage or conditions; or (d) other acts which are not the fault of MOTOROLA or MZGW, are excluded from coverage.

Use of Non-Motorola branded Products and Accessories. Defects or damage that result from the use of Non-Motorola branded or certified Products or Accessories or other peripheral equipment are excluded from coverage.

Unauthorized Service or Modification. Defects or damages resulting from service, testing, adjustment, installation, maintenance, alteration, or modification in any way by someone other than MOTOROLA, MZGW or its authorized service centers, are excluded from coverage.

Altered Products. Products or Accessories with (a) serial numbers or date tags that have been removed, altered or obliterated; (b) broken seals or that show evidence of tampering; (c) mismatched board serial numbers; or (d) nonconforming or non-Motorola branded housings, or parts, are excluded from coverage.

Communication Services. Defects, damages, or the failure of Products or Accessories due to any communication service or signal you may subscribe to or use with the Products or Accessories is excluded from coverage.

How to Obtain Warranty Service or Other Information?

To obtain service or information, please visit us at: motorolanursery.com/support

Exclusions

Normal Wear and Tear. Periodic maintenance, repair and replacement of parts due to normal wear and tear are excluded from coverage.

Abuse & Misuse. Defects or damage that result from: (a) improper operation, storage, misuse or abuse, accident or neglect, such as physical damage (cracks, scratches, etc.) to the surface of the product resulting from misuse; (b) contact with liquid, water, rain, extreme humidity or heavy perspiration, sand, dirt or the like, extreme heat, or food; (c) use of the Products or Accessories for commercial purposes or subjecting the Product or Accessory to abnormal usage or conditions; or (d) other acts which are not the fault of MOTOROLA or MZGW, are excluded from coverage.

Use of Non-Motorola branded Products and Accessories. Defects or damage that result from the use of Non-Motorola branded or certified Products or Accessories or other peripheral equipment are excluded from coverage.

Unauthorized Service or Modification. Defects or damages resulting from service, testing, adjustment, installation, maintenance, alteration, or modification in any way by someone other than MOTOROLA, MZGW or its authorized service centers, are excluded from coverage.

Altered Products. Products or Accessories with (a) serial numbers or date tags that have been removed, altered or obliterated; (b) broken seals or that show evidence of tampering; (c) mismatched board serial numbers; or (d) nonconforming or non-Motorola branded housings, or parts, are excluded from coverage.

Communication Services. Defects, damages, or the failure of Products or Accessories due to any communication service or signal you may subscribe to or use with the Products or Accessories is excluded from coverage.

How to Obtain Warranty Service or Other Information?

To obtain service or information, please visit us at: motorolanursery.com/support

4. Généralités

Si votre produit ne fonctionne pas correctement, lisez ce guide de démarrage ou le guide de l'utilisateur de l'un des modèles indiqués en page 1.

veuillez nous rendre visite à: motorolanursery.com/support

Exclusions

Garantie limitée pour les produits et accessoires grand public (« Garantie »)
Merci d'avoir acheté ce produit de marque Motorola fabriqué sous licence par Meizhou Guo Wei Electronics Co., Ltd. (« MZGW »).

Que couvre la présente Garantie ?

Sous réserve des exclusions indiquées ci-dessous, la société MZGW garantit que ce produit (« Produit ») de marque Motorola ou cet accessoire certifié et vendu pour être utilisé avec le Produit (« Accessoire ») fabriqué par MZGW est exempt de défauts de matériaux et de fabrication, sous réserve d'une utilisation normale pendant la période stipulée ci-dessous. La présente Garantie est votre unique garantie et n'est pas transférable.

LA PRÉSENTE GARANTIE VOUS CONFÈRE DES DROITS LÉGAUX SPÉCIFIQUES ; IL EST POSSIBLE QUE VOUS AYEZ D'AUTRES DROITS POUVANT VARIER EN FONCTION DE L'ÉTAT, DE LA RÉGION OU DU PAYS. POUR LES CONSOMMATEURS COUVERTS PAR LES LOIS ET RÉGLEMENTATIONS DE PROTECTION DES CONSOMMATEURS DANS LE PAYS D'ACHAT OU, S'IL DIFFÈRE, DANS LEUR PAYS DE RÉSIDENCE, LES AVANTAGES OCTROYÉS PAR LA PRÉSENTE GARANTIE LIMITÉE SONT ACCORDÉS EN SUS DE L'ENSEMBLE DES DROITS ET RECOURS CONFERÉS PAR LESDITES LOIS ET LESDITES RÉGLEMENTATIONS DE PROTECTION DES CONSOMMATEURS. POUR UNE BONNE COMPRÉHENSION DE VOS DRGITS, CONSULTEZ LA LÉGISLATION DE VOTRE PAYS, PROVINCE OU ÉTAT.

Qui est couvert par la présente Garantie ?

La présente Garantie couvre uniquement le premier acheteur du Produit et n'est pas transférable.

Que fera MZGW ?

MZGW ou son distributeur agréé réparera ou remplacera gratuitement, à sa discrétion et pendant une période commercialement raisonnable, tout Produit ou Accessoire qui ne serait pas conforme à la présente Garantie. Nous pourrons utiliser des Produits, Accessoires ou pièces remis à neuf, d'occasion ou neufs, dont les fonctionnalités sont équivalentes.

Exclusions

Normal Wear and Tear. Periodic maintenance, repair and replacement of parts due to normal wear and tear are excluded from coverage.

Abuse & Misuse. Defects or damage that result from: (a) improper operation, storage, misuse or abuse, accident or neglect, such as physical damage (cracks, scratches, etc.) to the surface of the product resulting from misuse; (b) contact with liquid, water, rain, extreme humidity or heavy perspiration, sand, dirt or the like, extreme heat, or food; (c) use of the Products or Accessories for commercial purposes or subjecting the Product or Accessory to abnormal usage or conditions; or (d) other acts which are not the fault of MOTOROLA or MZGW, are excluded from coverage.

Use of Non-Motorola branded Products and Accessories. Defects or damage that result from the use of Non-Motorola branded or certified Products or Accessories or other peripheral equipment are excluded from coverage.

Unauthorized Service or Modification. Defects or damages resulting from service, testing, adjustment, installation, maintenance, alteration, or modification in any way by someone other than MOTOROLA, MZGW or its authorized service centers, are excluded from coverage.

Altered Products. Products or Accessories with (a) serial numbers or date tags that have been removed, altered or obliterated; (b) broken seals or that show evidence of tampering; (c) mismatched board serial numbers; or (d) nonconforming or non-Motorola branded housings, or parts, are excluded from coverage.

Communication Services. Defects, damages, or the failure of Products or Accessories due to any communication service or signal you may subscribe to or use with the Products or Accessories is excluded from coverage.

How to Obtain Warranty Service or Other Information?

To obtain service or information, please visit us at: motorolanursery.com/support

Exclusions

Normal Wear and Tear. Periodic maintenance, repair and replacement of parts due to normal wear and tear are excluded from coverage.

Abuse & Misuse. Defects or damage that result from: (a) improper operation, storage, misuse or abuse, accident or neglect, such as physical damage (cracks, scratches, etc.) to the surface of the product resulting from misuse; (b) contact with liquid, water, rain, extreme humidity or heavy perspiration, sand, dirt or the like, extreme heat, or food; (c) use of the Products or Accessories for commercial purposes or subjecting the Product or Accessory to abnormal usage or conditions; or (d) other acts which are not the fault of MOTOROLA or MZGW, are excluded from coverage.

Use of Non-Motorola branded Products and Accessories. Defects or damage that result from the use of Non-Motorola branded or certified Products or Accessories or other peripheral equipment are excluded from coverage.

Unauthorized Service or Modification. Defects or damages resulting from service, testing, adjustment, installation, maintenance, alteration, or modification in any way by someone other than MOTOROLA, MZGW or its authorized service centers, are excluded from coverage.

Altered Products. Products or Accessories dont : (a) les numéros de série ou l'étiquette de date ont été enlevés, altérés ou effacés ; (b) le sceau est brisé ou montre des signes évidents de manipulation ; (c) les numéros de série des cartes ne correspondent pas ; ou (d) les boîtiers ou certaines pièces ne sont pas conformes ou sont d'une marque autre que Motorola, ne sont pas couverts par la présente Garantie.

Services de communications. Les défauts, dégâts ou défaillances des produits ou accessoires causés par tout service ou signal de communication auquel vous êtes abonné, ou que vous utilisez avec les produits ou accessoires, ne sont pas couverts par la présente Garantie.

Comment faire réparer votre appareil sous garantie ou obtenir d'autres informations ?

Pour faire réparer votre appareil sous garantie ou obtenir d'autres informations, veuillez nous rendre visite à: motorolanursery.com/support

Exclusions

Normal Wear and Tear. Periodic maintenance, repair and replacement of parts due to normal wear and tear are excluded from coverage.

Abuse & Misuse. Defects or damage that result from: (a) improper operation, storage, misuse or abuse, accident or neglect, such as physical damage (cracks, scratches, etc.) to the surface of the product resulting from misuse; (b) contact with liquid, water, rain, extreme humidity or heavy perspiration, sand, dirt or the like, extreme heat, or food; (c) use of the Products or Accessories for commercial purposes or subjecting the Product or Accessory to abnormal usage or conditions; or (d) other acts which are not the fault of MOTOROLA or MZGW, are excluded from coverage.

Use of Non-Motorola branded Products and Accessories. Defects or damage that result from the use of Non-Motorola branded or certified Products or Accessories or other peripheral equipment are excluded from coverage.

Unauthorized Service or Modification. Defects or damages resulting from service, testing, adjustment, installation, maintenance, alteration, or modification in any way by someone other than MOTOROLA, MZGW or its authorized service centers, are excluded from coverage.

Altered Products. Products or accessories dont : (a) les numéros de série ou l'étiquette de date ont été enlevés, altérés ou effacés ; (b) le sceau est brisé ou montre des signes évidents de manipulation ; (c) les numéros de série des cartes ne correspondent pas ; ou (d) les boîtiers ou certaines pièces ne sont pas conformes ou sont d'une marque autre que Motorola, ne sont pas couverts par la présente Garantie.

Services de communications. Les défauts, dégâts ou défaillances des produits ou accessoires causés par tout service ou signal de communication auquel vous êtes abonné, ou que vous utilisez avec les produits ou accessoires, ne sont pas couverts par la présente Garantie.

Comment faire réparer votre appareil sous garantie ou obtenir d'autres informations ?

Pour faire réparer votre appareil sous garantie ou obtenir d'autres informations, veuillez nous rendre visite à: motorolanursery.com/support

Exclusions

Normal Wear and Tear. Periodic maintenance, repair and replacement of parts due to normal wear and tear are excluded from coverage.

Abuse & Misuse. Defects or damage that result from: (a) improper operation, storage, misuse or abuse, accident or neglect, such as physical damage (cracks, scratches, etc.) to the surface of the product resulting from misuse; (b) contact with liquid, water, rain, extreme humidity or heavy perspiration, sand, dirt or the like, extreme heat, or food; (c) use of the Products or Accessories for commercial purposes or subjecting the Product or Accessory to abnormal usage or conditions; or (d) other acts which are not the fault of MOTOROLA or MZGW, are excluded from coverage.

Use of Non-Motorola branded Products and Accessories. Defects or damage that result from the use of Non-Motorola branded or certified Products or Accessories or other peripheral equipment are excluded from coverage.

Unauthorized Service or Modification. Defects or damages resulting from service, testing, adjustment, installation, maintenance, alteration, or modification in any way by someone other than MOTOROLA, MZGW or its authorized service centers, are excluded from coverage.

4. Información general

Si su producto no está funcionando correctamente, lea esta Guía rápida de inicio o la Guía de usuario de uno de los modelos que se mencionan en la página 1.

visítenos en: motorolanursery.com/support

Exclusions

Garantía limitada para productos y accesorios de consumo (“Garantía”)
Gracias por comprar este producto de marca Motorola fabricado bajo licencia otorgada por Meizhou Guo Wei Electronics Co., Ltd (“MZGW”).

¿Qué cobertura tiene esta Garantía?

Sujeto a las exclusiones que aquí se detallan, MZGW garantiza que este producto de marca Motorola (“Producto”) o todo accesorio certificado (“Accesorio”) que se vende para ser utilizado con este producto que fabrica están libres de defectos en los materiales y mano de obra conforme a condiciones normales de uso por parte del consumidor para el periodo que se detalla a continuación. La presente Garantía es de carácter exclusivo y no es transferible.

ESTA GARANTÍA LE OTORGA DERECHOS LEGALES ESPECÍFICOS, Y ES POSIBLE QUE USTED TAMBIÉN CUENTE CON OTROS DERECHOS QUE VARIÁN SEGÚN EL ESTADO, LA PROVINCIA O EL PAÍS. PARA CONSUMIDORES QUE ESTÉN CUBIERTOS POR LAS LEYES O REGULACIONES DE PROTECCIÓN AL CONSUMIDOR EN EL PAÍS EN QUE SE HAYA COMPRADO EL PRODUCTO O, SU PAÍS DE RESIDENCIA, LOS BENEFICIOS QUE OFRECE ESTA GARANTÍA LIMITADA SE SUMAN A TODOS LOS DERECHOS Y RECURSOS QUE CONCEDAN DICHAS LEYES Y REGULACIONES DE PROTECCIÓN AL CONSUMIDOR. PARA CONOCER A FONDO SUS DERECHOS DEBERÁ CONSULTAR LAS LEYES DE SU PAÍS, PROVINCIA O ESTADO.

¿Quién está cubierto?

La presente Garantía cubre solamente al primer comprador usuario y no es transferible.

¿Qué hará MZGW o su distribuidor autorizado según su criterio y dentro de un período de tiempo comercialmente razonable, reparará o reemplazará sin cargo todo Producto o Accesorio que no se ajuste a esta Garantía. Posiblemente se utilicen Productos, Accesorios o partes funcionalmente similares reacondicionadas/reparadas/usadas o nuevas.

Exclusions

Normal Wear and Tear. Periodic maintenance, repair and replacement of parts due to normal wear and tear are excluded from coverage.

Abuse & Misuse. Defects or damage that result from: (a) improper operation, storage, misuse or abuse, accident or neglect, such as physical damage (cracks, scratches, etc.) to the surface of the product resulting from misuse; (b) contact with liquid, water, rain, extreme humidity or heavy perspiration, sand, dirt or the like, extreme heat, or food; (c) use of the Products or Accessories for commercial purposes or subjecting the Product or Accessory to abnormal usage or conditions; or (d) other acts which are not the fault of MOTOROLA or MZGW, are excluded from coverage.

Use of Non-Motorola branded Products and Accessories. Defects or damage that result from the use of Non-Motorola branded or certified Products or Accessories or other peripheral equipment are excluded from coverage.

Unauthorized Service or Modification. Defects or damages resulting from service, testing, adjustment, installation, maintenance, alteration, or modification in any way by someone other than MOTOROLA, MZGW or its authorized service centers, are excluded from coverage.

Altered Products. Products or Accessories dont : (a) les numéros de série ou l'étiquette de date ont été enlevés, altérés ou effacés ; (b) le sceau est brisé ou montre des signes évidents de manipulation ; (c) les numéros de série des cartes ne correspondent pas ; ou (d) les boîtiers ou certaines pièces ne sont pas conformes ou sont d'une marque autre que Motorola, ne sont pas couverts par la présente Garantie.

Services de communications. Les défauts, dégâts ou défaillances des produits ou accessoires causés par tout service ou signal de communication auquel vous êtes abonné, ou que vous utilisez avec les produits ou accessoires, ne sont pas couverts par la présente Garantie.

Comment faire réparer votre appareil sous garantie ou obtenir d'autres informations ?

Pour faire réparer votre appareil sous garantie ou obtenir d'autres informations, veuillez nous rendre visite à: motorolanursery.com/support

Exclusions

Normal Wear and Tear. Periodic maintenance, repair and replacement of parts due to normal wear and tear are excluded from coverage.

Abuse & mal uso. Defectos o daño como resultado de: (a) operación o almacenamiento impropio, mal uso o abuso, accidente o negligencia, como por ejemplo el daño físico (fisuras, rayones, etc.) en la superficie del producto como resultado del mal uso; (b) contacto con líquido, agua, lluvia, humedad extrema o transpiración fuerte, arena, suciedad o similares, calor excesivo o alimento; (c) uso de los Productos o Accesorios para fines comerciales o sometimiento de los Productos o Accesorios a un uso o condiciones de uso anormales; o (d) otros actos que no son responsabilidad o negligencia de MOTOROLA o MZGW, quedan excluidos de la cobertura.

Use de Productos y Accesorios que no pertenecen a la marca Motorola. Los defectos o daños que resultan del uso de Productos o Accesorios u otros equipos periféricos no certificados por Motorola o no pertenecientes a esta marca quedan excluidos de la cobertura.

Reparación o Modificación no autorizada. Los defectos o daños que resulten de la reparación, prueba, ajuste, instalación, mantenimiento, alteración o modificación de cualquier forma por una persona que no pertenezca a MOTOROLA, MZGW o a sus centros de servicio autorizados, quedan excluidos de la cobertura.

Productos alterados. Los Productos o Accesorios con (a) números de serie o etiquetas con fecha que hayan sido eliminados, alterados o anulados; (b) sellos rotos o que muestren evidencia de adulteración; (c) números de serie no coincidentes; o (d) revestimientos o partes que no pertenezcan a la marca Motorola o no se adecuen quedan excluidos de la cobertura.

Servicios de comunicación. Los defectos, daño o falla de los Productos o Accesorios debido a cualquier tipo de servicio de comunicación o señal a la que esté suscrito o utilice con los Productos o Accesorios quedan excluidos de la cobertura.

¿Cómo obtener el servicio de garantía u otra información?

Para obtener servicio o información, visítenos en: motorolanursery.com/support

Exclusions

Normal Wear and Tear. Periodic maintenance, repair and replacement of parts due to normal wear and tear are excluded from coverage.

Abuse & Misuse. Defects or damage that result from: (a) improper operation, storage, misuse or abuse, accident or neglect, such as physical damage (cracks, scratches, etc.) to the surface of the product resulting from misuse; (b) contact with liquid, water, rain, extreme humidity or heavy perspiration, sand, dirt or the like, extreme heat, or food; (c) use of the Products or Accessories for commercial purposes or subjecting the Product or Accessory to abnormal usage or conditions; or (d) other acts which are not the fault of MOTOROLA or MZGW, are excluded from coverage.

Use of Non-Motorola branded Products and Accessories. Defects or damage that result from the use of Non-Motorola branded or certified Products or Accessories or other peripheral equipment are excluded from coverage.

Unauthorized Service or Modification. Defects or damages resulting from service, testing, adjustment, installation, maintenance, alteration, or modification in any way by someone other than MOTOROLA, MZGW or its authorized service centers, are excluded from coverage.

Altered Products. Products or accessories dont : (a) les numéros de série ou l'étiquette de date ont été enlevés, altérés ou effacés ; (b) le sceau est brisé ou montre des signes évidents de manipulation ; (c) les numéros de série des cartes ne correspondent pas ; ou (d) les boîtiers ou certaines pièces ne sont pas conformes ou sont d'une marque autre que Motorola, ne sont pas couverts par la présente Garantie.

Services de communications. Les défauts, dégâts ou défaillances des produits ou accessoires causés par tout service ou signal de communication auquel vous êtes abonné, ou que vous utilisez avec les produits ou accessoires, ne sont pas couverts par la présente Garantie.

Comment faire réparer votre appareil sous garantie ou obtenir d'autres informations ?

Pour faire réparer votre appareil sous garantie ou obtenir d'autres informations, veuillez nous rendre visite à: motorolanursery.com/support

Exclusions

Normal Wear and Tear. Periodic maintenance, repair and replacement of parts due to normal wear and tear are excluded from coverage.

Abuse & Misuse. Defects or damage that result from: (a) improper operation, storage, misuse or abuse, accident or neglect, such as physical damage (cracks, scratches, etc.) to the surface of the product resulting from misuse; (b) contact with liquid, water, rain, extreme humidity or heavy perspiration, sand, dirt or the like, extreme heat, or food; (c) use of the Products or Accessories for commercial purposes or subjecting the Product or Accessory to abnormal usage or conditions; or (d) other acts which are not the fault of MOTOROLA or MZGW, are excluded from coverage.

Use of Non-Motorola branded Products and Accessories. Defects or damage that result from the use of Non-Motorola branded or certified Products or Accessories or other peripheral equipment are excluded from coverage.

Unauthorized Service or Modification. Defects or damages resulting from service, testing, adjustment, installation, maintenance, alteration, or modification in any way by someone other than MOTOROLA, MZGW or its authorized service centers, are excluded from coverage.



Printed in China

Version 3 (EN_US)



Printed in China

Version 3 (FR_CA)



Printed in China

Version 3 (ES_LA)